

# Zoom Camera

# ATC-UZ5707U-H



- 1/1" Progressive Scan Global Shutter CMOS
- 84x AF Zoom(7x optical zoom, 12x digital zoom)
- 4K UHD (3840 x 2160 / 30fps)
- Mechanical Day&Night
- True WDR
- 3D DNR, Defog
- UART RS232-TTL(Pleco-D, Pelco C, VISCA, Hitachi)
- P-IRIS

# ATC-UZ5707U-H



· Dimensions

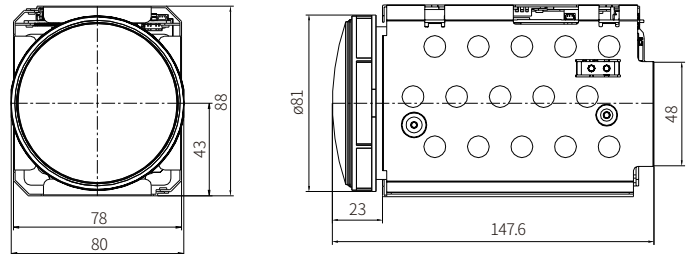

## Specifications

|                                    |  |   |
|------------------------------------|--|---|
| <b>Image Sensor</b>                | 1/1" Progressive Scan Global Shutter CMOS  |   |
| <b>Effective Pixels</b>            | 8.95MP 4112(H) x 2176(V)   |   |
| <b>Video Output mode</b>           | HDMI(1.4b) / CVBS  |   |
| <b>Max. Video Resolution</b>       | HDMI(1.4a) : 3840x2160@30fps   |   |
| <b>Synchronization system</b>      | Internal   |   |
| <b>Min.Illumination</b>            | Day mode: 0.1(Lux(F1.6)<br>Night mode: 0.06Lux(F1.6/ IR-cut filter on)<br>Sens-Up off, AGC28dB |   |
| <b>S/N Rate</b>                    | More than 52dB(AGC off, Sens-Up off)   |   |
| <b>Lens</b>                        | <b>Type</b>  | AF Optical zoom lens(P-Iris)                                  |
|                                    | <b>Focal Length</b>  | f=12mm~84mm   |
|                                    | <b>F-value</b>   | F1.5(W)~2.6(T)  |
|                                    | <b>Angle of View</b>   | Horizontal 61.19°(W)~9.66°(T),<br>Vertical 34.75°(W)~5.12°(T) |
| <b>Zoom ratio</b>                  | Optical 7x / Digital 12x   |   |
| <b>Focus Min.Working Distance</b>  | 0.5m(Wide)/2.5m(Tele)~∞  |   |
| <b>Focus Control</b>               | Auto/Manual/Interval/One Push/Preset   |   |
| <b>AE mode</b>                     | Auto/Shutter Priority/Iris Priority/Manual   |   |
| <b>Brightness</b>                  | 0~14   |   |
| <b>Manual Shutter</b>              | 1/1, 1/2, 1/4(3), 1/8(6), 1/15(12), 1/30(25), 1/60(50)~1/10000                                 |   |
| <b>Manual Iris</b>                 | F1.5~F32, Close  |   |
| <b>Sense-up</b>                    | Off~32fields   |   |
| <b>ETC</b>                         | Spot AE, Slow AE   |   |
| <b>D&amp;N Mode</b>                | Auto/Day(Color)/Night(BW)/External-H or L  |   |
| <b>White Balance</b>               | AUTO/ATW/Indoor/Outdoor/OnePush/Manual   |   |
| <b>Image Freeze</b>                | Off/On   |   |
| <b>Image Flip</b>                  | Off/Horizontal/Vertical/H+V(180°Flip)  |   |
| <b>Privacy Mask Zone</b>           | 16 Zones/14 mask color selectable, semi-transparency   |   |
| <b>Digital Image Stabilization</b> | Yes  |   |
| <b>Motion Detection</b>            | 4 Zones  |   |

|                              |  |  |
|------------------------------|--|--|
| <b>D-WDR</b>                 | Off/Low/Middle/High  |  |
| <b>WDR</b>                   | Off/Low/Middle/High  |  |
| <b>BLC</b>                   | Off/On, Area selectable  |  |
| <b>HLC</b>                   | Off/0~20, Color selectable   |  |
| <b>AGC</b>                   | Max.48dB   |  |
| <b>Sharpness</b>             | Adjustable(0~15)   |  |
| <b>3D-DNR</b>                | On/Off(1~5)  |  |
| <b>2D-DNR</b>                | Auto/Manual  |  |
| <b>Defog</b>                 | Off/Low/Middle/High  |  |
| <b>Preset Position</b>       | 256 position Presets(Zoom,Focus),<br>16Memory Presets, Custom Preset |  |
| <b>Language</b>              | English  |  |
| <b>UART</b>                  | <b>Remote</b>  | RS232 TTL +5.0V(+3.3V compatible)                  |
|                              | <b>Protocol</b>  | VISCA/Pelco-D/Pelco-P/Hitachi: Automatic detection |
|                              | <b>Baud rate</b>   | 2400/4800/9600/19200/38400/57600/115200bps         |
| <b>UTC</b>                   | -  |  |
| <b>Supply Voltage</b>        | 12VDC(9V to 15VDC)   |  |
| <b>Power Consumption</b>     | Max.8.7W / Non-working zoom&focus 6.9W                               |  |
| <b>Dimension(mm)</b>         | 80x88x147.6mm  |  |
| <b>Weight</b>                | Approx.885g  |  |
| <b>Operating Temperature</b> | -10°C~+50°C, Humidity(20~80%)  |  |
| <b>Storage Temperature</b>   | -20°C~+60°C, Humidity(20~95%)  |  |