

WAT-3200

1/2.8" High Sensitivity 3G/HD-SDI B&W camera

Added B&W version to the 3G/HD-SDI camera series

NEW



***NO CE & FCC**

Key features

- 1/2.8-inch BSI CMOS image sensor with high sensitivity
- Full HD 1080/60p resolution with 3G-SDI/HD-SDI interface and low latency
- Min. illumination 0.0001lx F1.4 (AGC HIGH=72dB Shutter=OFF)
0.000007x F1.4 (AGC HIGH=72dB, Shutter=x15)

Dimensions

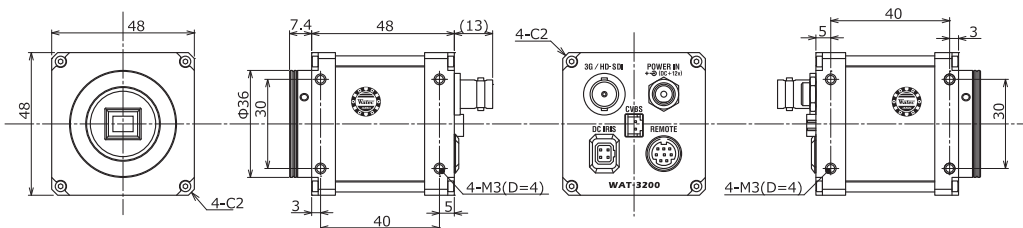

Specifications

| | | | |
|---------------------------------|---|---|---|
| Pick-up Element | 1/2.8 inch BSI CMOS image sensor | | |
| Number of Effective Pixels | 1945(H) × 1097(V) | | |
| Unit Cell Size | 2.9µm(H) × 2.9µm(V) | | |
| Imaging System | — | | |
| Synchronizing System | Internal | | |
| Scanning System | Progressive | | |
| Video Outputs | 3G-SDI, HD-SDI | | |
| Output Format | Composite video:1.0 V(p-p) 75Ω (Unbalanced) 1080/60p, 1080/59.94p, 1080/50p, 1080/60i, 1080/59.94i, 1080/50i, 1080/30p, 1080/29.97p, 1080/25p,1080/24p, 720/60p, 720/59.94p, 720/50p, NTSC, PAL | | |
| Resolution(H) | More than 1000TVL (Center) | | |
| Min. Illumination | 0.0001 lx F1.4 (AGC HIGH=72dB, Shutter=OFF) 0.000007 F1.4 (AGC HIGH=72dB, Shutter=x15) | | |
| S/N | More than 50dB (AGC OFF=0dB, γ=1.0) | | |
| Function Setting | OSD : Remote controller, RS-232 (Pelco-D, Pelco-P), Communication: RS-232 (Pelco-D, Pelco-P, Visca) | | |
| AE Mode | Fixed | x2, x3, x4, x5, x6, x7, x8, x9, x10, x12, x15 (frame) | |
| | | 1/30, 1/60, 1/120, 1/180, 1/240, 1/300 sec.*1 | 1/25, 1/50, 1/100, 1/150, 1/200, 1/250 sec.*2 |
| | | 1/500, 1/1000, 1/2000, 1/5000, 1/10000 sec. | |
| EI | 1/30 - 1/10000 sec.*1 | | |
| | 1/25 - 1/10000 sec.*2 | | |
| White Balance | x15 - 1/10000 sec. | | |
| | — | | |
| AGC | ON | 0 - 36dB(LOW), 0 - 50dB(MID), 0 - 72dB(HIGH) | |
| | OFF | 0dB | |
| MGC | 0 - 72dB (5dB Step) | | |
| Day/Night | — | | |
| Gamma Characteristics | γ=USER (Level adjustable) | | |
| Noise Reduction | 3DNR OFF/ON Level adjustable, 2DNR OFF/ON Level adjustable, 3D+2DNR ON Level adjustable | | |
| Wide Dynamic Range | WDR OFF/ON Level adjustable, D-WDR OFF/ON Level adjustable | | |
| Lens Iris | DC | | |
| Back Light Compensation | BLC, HSBLC | | |
| White Blemish Correction | Up to 2046 pixels | | |
| Sharpness | OFF/ON Level adjustable | | |
| Defog | OFF/ON Level adjustable | | |
| Digital Zoom | ZOOM (x1.01 - x6.00), PAN/TILT | | |
| Privacy Mask | 8 masks | | |
| Mirror Image | OFF, V-FLIP, H-FLIP, HV-FLIP | | |
| Freeze | OFF/ON | | |
| Motion Detection | OFF/ON 4 areas arbitrarily configurable | | |
| Neg. Image | OFF/ON | | |
| Interface | BNC (3G/HD-SDI), 2P connector (Composite video), Power in, Auto iris, miniDIN8P (RC-02, RS-232) | | |
| Power Supply | DC+12V ±10% | | |
| Power Consumption | 2.52W (210mA) | | |
| Operating / Storage Temperature | -10 - +50°C / -30 - +70°C | | |
| Operating / Storage Humidity | 95%RH or Less (Without condensation) | | |
| Lens Mount | CS mount | | |
| Weight | Approx. 130g | | |
| Accessories | WPDC12-R (DC plug), 2P cable, Hex. wrench, Camera bracket, RC-02 (Remote control) | | |

*1 Output Format: 60/59.94/30fps *2 Output Format: 50/25/24fps

