



Venue-wide Synchronized Video Satisfies Various Needs



Uncompressed & Ultra-low Latency
4K/60Hz AV Over IP

AVLINK[®]
The Highest Quality AV Solutions



One IPS, More Applications

The IPS series support video modes including matrix switch, multi-view display, video wall, and KVM.

The IPS series also support Power over Ethernet (PoE) and enable ultra-low latency A/V signal at 4K/60Hz 4:4:4 over a 10-Gigabit network to display crystal-clear video in multiple applications.



Hospitality / Corporate Applications

Customization Achieves Venue-wide Audiovisual Content





Industry /

Transportation Applications

Crystal-clear Video Helps Monitor the Work of the Equipment

Ultra-low Latency Enables Audiences to Cheer Simultaneously



Entertainment / Esports Applications



Retail / House of Worship Applications

Flexible Installation Satisfies Diversified Scenarios





Education / Healthcare Applications

Synchronized A/V Content
Contributes Immersive Learning





Government / Military Applications

Made in Taiwan and
Quality Guaranteed



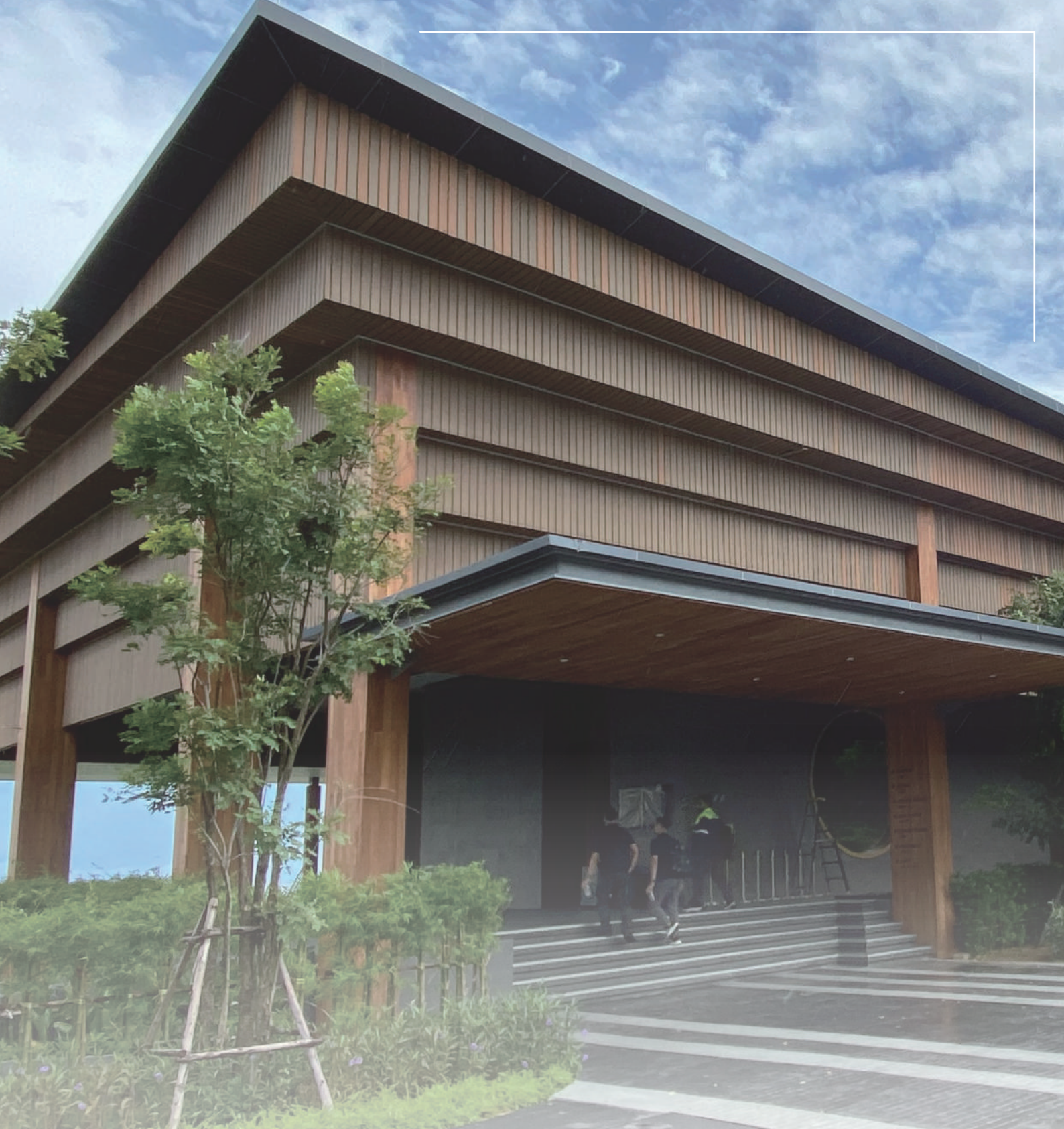

Testimony

AV LINK's APIs (Application Programming Interfaces) help us to integrate the IPS devices with the existing environmental control system and transport the video to multiple meeting rooms and event spaces.

— The Team of Intelcraft Solution, The Representative for Connex Sriracha
(A Meeting and Wedding Venue in Thailand)



4K/60Hz AV over IP



IPS-AC / AF Features

HDMI Input	<ul style="list-style-type: none">• True 4K/60Hz 4:4:4, HDR• HDMI 2.0 compatible input port• Support HDCP 1.4 and 2.2
HDMI Output	<ul style="list-style-type: none">• True 4K/60Hz 4:4:4, HDR• HDMI 2.0 compatible output port• Support HDCP 1.4 and 2.2• Multi-view mode: The video format keeps RGB 8-bit
10G-SFP+Transport	XFI interface <ul style="list-style-type: none">• 10GBASE-T 100m with Cat 6a cable• Multi-mode fiber 300/500m with OM3/OM4 fiber• Single-mode fiber up to 30KM
Power over Ethernet (PoE)	<ul style="list-style-type: none">• Support Type : PoE+/PD• IPS-AC only
Video Routing	<ul style="list-style-type: none">• Lightweight 1.4 to 1 artifact-free compression• Time to switch between sources in under 100 milliseconds.• Support Transceiver Mode (Simultaneous transmitter and receiver, IPS-AX only)
Audio Routing	<ul style="list-style-type: none">• Lossless audio transmission• HDMI downmixed stereo channel• Support Microphone Input (with Bias voltage)
1G Control Interface	<ul style="list-style-type: none">• Extension of Gigabit Ethernet data network• Built-in Ethernet switch connects 1GbE Ethernet to 10GbE interface• Device Control
USB Routing	<ul style="list-style-type: none">• USB port: Up to 480 Mbps• USB HID port: Only support Human Interface Devices
RS232 Routing	<ul style="list-style-type: none">• Baud rate up to 115200• Unicast and broadcast routing between devices• Serial data routing between multiple devices
IR Routing	<ul style="list-style-type: none">• IR data routing between multiple devices
Video Scaling	<ul style="list-style-type: none">• Upscaling (Video Wall) and downscaling (Multi-view)• Multi-source video compositing• Video Wall processing with bezel correction and display synchronization